

## PRODUCT INFORMATION



INTEGRATED CAMERA SOLUTIONS

# MGDS4

MINIGLOBE SERIES: DETENTION GRADE

The detention grade MiniGlobe (MGDS4) provides a tamper-resistant, integrated solution for a variety of security applications. The MGDS4 includes a high-quality camera, lens and impact-resistant housing. Use the MGDS4 in critical public locations and anywhere with low (10 feet or less) ceilings. It is an ideal solution for prisons, schools, institutions and government facilities.

Part of the MiniGlobe line, the surface-mount MGDS4 is designed for quick and simple installation. The MGDS4 will mount easily to a standard 4" octagonal junction box (other mounting options are available). It comes with a clear, polycarbonate dome and camera-concealing liner.

The MGDS4 accommodates an extensive variety of cameras including high resolution color, true day/night and wide dynamic range. DSP chip technology features Auto White Balance, Auto Gain Control, and Backlight Compensation.

The MGDS4 delivers excellent quality in an easy-to-install, versatile, integrated product—an exceptional solution for high security applications.

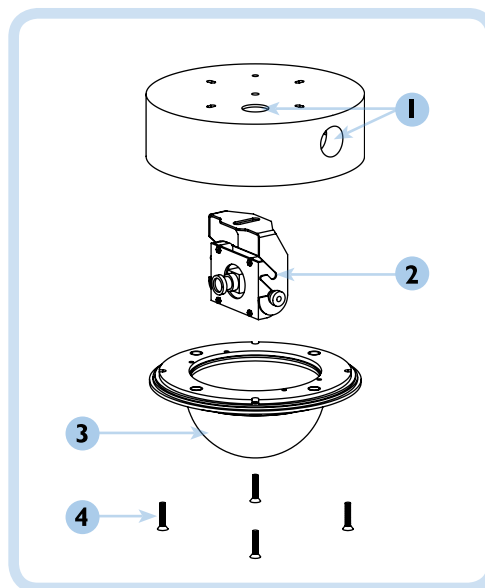

### FEATURES

- **Vandal-resistant housing**
- **Impact-resistant dome**
- **Cast aluminum construction**
- **Integrated camera, lens and housing solution**
- **Extensive camera options including high resolution color, true day/night, and wide dynamic range**
- **Five year product warranty**

### HIGHLIGHTS

- 1) Side and top cable access ports
- 2) Multiple camera options
- 3) Impact-resistant dome
- 4) Tamper-resistant screws



The Power to See  
Your Business<sup>SM</sup>

## TECHNICAL SPECIFICATIONS

### DIMENSIONS

( All Dimensions Are in Inches )

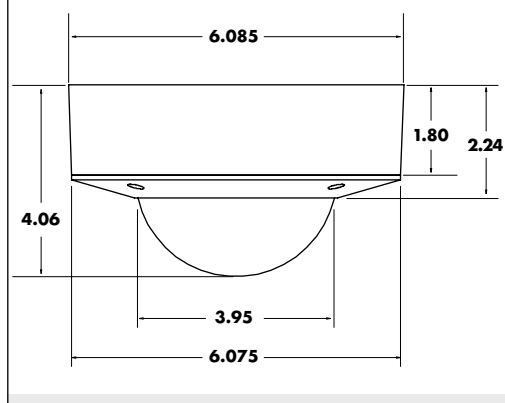

### MECHANICAL PROPERTIES

|             |  |
|-------------|--|
| Upper Unit  | Cast aluminum  |
| Lower Unit  | Cast aluminum trim ring with polycarbonate dome              |
| Hardware    | Heavy-gauge steel construction with black powder-coat finish |
| Unit Weight | 3.0 lbs (Shipping Weight = 3.7 lbs)                          |

### ELECTRICAL PROPERTIES

|                       |                             |
|-----------------------|-----------------------------|
| Input Voltage         | 24VAC +/- 10%               |
| Power Consumption     | 3.5 - 4.5W                  |
| Video Connections     | BNC                         |
| Video Output          | 1.0 V p-p, 75 Ohm composite |
| Operating Temperature | -10 to 55 degrees C         |

### RECOMMENDED POWER SUPPLIES

|               |   |
|---------------|---|
| MPS24A series | Power supplies for 24VAC cameras. Multiple camera application—4, 8, and 16 outputs. (Contact Wren for amperage specifications.) |
|---------------|---|

### RECOMMENDED MOUNTING

4" Octagonal junction box or equivalent (Steel City® part #54151-1/2)

| CAMERA SPECS                  | HI RES COLOR                | TRUE DAY/NIGHT                                   | WIDE DYNAMIC RANGE          |
|-------------------------------|-----------------------------|--|-----------------------------|
| <b>Image Device</b>           | 1/3" Sony CCD Image Sensor  | 1/3" Sony CCD Image Sensor                       | 1/3" Sony CCD Image Sensor  |
| <b>Picture Elements</b>       | 768H x 494V                 | 768H x 494V                                      | 768H x 494V                 |
| <b>Resolution</b>             | 480 TVL                     | 480 TVL  | 480 TVL                     |
| <b>Scanning System</b>        | 2:1 Interlaced              | 2:1 Interlaced                                   | 2:1 Interlaced              |
| <b>Min. Illumination</b>      | 0.4 lux (F2.0)              | Color: 0.4 lux (F2.0)<br>B&W: 0.0 lux with IR on | 1.0 lux (F1.2)              |
| <b>S/N Ratio</b>              | > 46dB                      | > 46dB   | > 46dB                      |
| <b>Shutter Speed</b>          | Up to 1/100,000             | Up to 1/100,000                                  | Up to 1/100,000             |
| <b>Synchronization System</b> | Internal                    | Internal   | Internal                    |
| <b>Auto Gain Control</b>      | On/Off Switchable           | On/Off Switchable                                | On/Off Switchable           |
| <b>Auto Iris Lens</b>         | 2.8 - 10 mm                 | 2.8 - 10 mm                                      | 2.8 - 10 mm                 |
| <b>White Balance</b>          | Automatic                   | Automatic  | ATC/AWB switchable          |
| <b>Backlight Compensation</b> | On/Off Switchable           | On/Off Switchable                                | Automatic                   |
| <b>Video Output</b>           | 1.0 Vp-p, 75 Ohm Composite  | 1.0 Vp-p, 75 Ohm Composite                       | 1.0 Vp-p, 75 Ohm Composite  |
| <b>Power Supply</b>           | 24VAC/12VDC +/- 10%, < 3.0W | 24VAC/12VDC +/- 10%, < 3.0W                      | 24VAC/12VDC +/- 10%, < 3.0W |
| <b>Weight</b>                 | 3 ounces/84.9 grams         | 3 ounces/84.9 grams                              | 3 ounces/84.9 grams         |
| <b>Operating Temperature</b>  | -10 to 50 C                 | -10 to 50 C                                      | -10 to 50 C                 |



**Wren, 124 Wren Parkway, Jefferson City, MO 65109 USA**  
**telephone (573) 893-2249 ■ toll-free (800) 881-2249 ■ facsimile (877) 893-2317**  
**solutions@wrensolutions.com ■ wrensolutions.com**

Wren®, the Wren logo, The Power to See Your Business, Wren IP Solutions, No Tools Required and Solution Set Series are trademarks of Wren. The trademarks that are followed by ® are registered trademarks in the U.S. All other trademarks and/or registered trademarks mentioned herein are properties of their respective owners and are used for reference purposes only. The use of these trademarks does not indicate any affiliation with or sponsorship of or by Wren. ©2007 Wren. All rights reserved.

8L124 Rev-G (01/29/07)  
Doc MD 7.2.210.11